

3/8" BORE BRASS MINIMATIC® CYLINDER



3BDS-□

Mount: Block **Available Stroke Lengths:** 1", 2", 3", 4", 5", 6"
Type: Double Acting

To order: Add stroke length to the end of the part number

Add -T to the end of the part number after stroke for a #5-40 x 1/2" rod thread

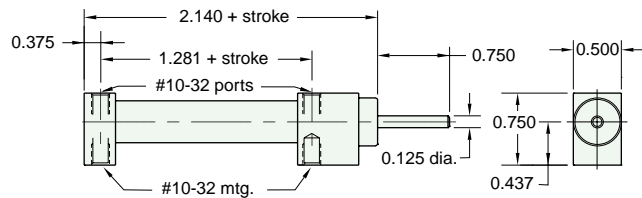

3BDD-□

Mount: Block **Available Stroke Lengths:** 1", 2", 3", 4"
Type: Double Acting
 Double Rod

To order: Add stroke length to the end of the part number

Add -T to the end of the part number after stroke for a #5-40 x 1/2" rod thread

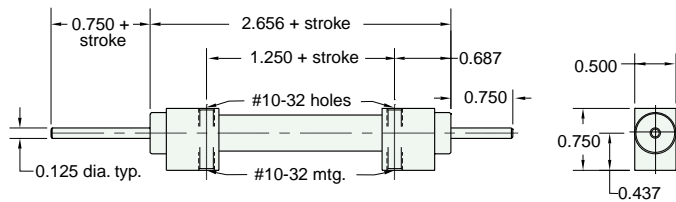

3SD-□

Mount: Stud **Available Stroke Lengths:** 1", 2", 3", 4"
Type: Double Acting

To order: Add stroke length to the end of the part number

Add -T to the end of the part number after stroke for a #5-40 x 1/2" rod thread

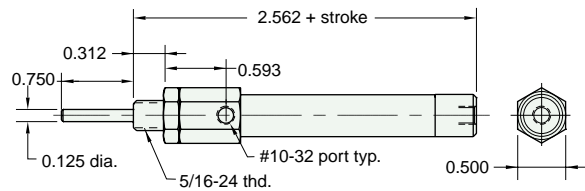

Nut included, but not shown on drawing

3CD-□

Mount: Clevis **Available Stroke Lengths:** 1", 2", 3", 4"
Type: Double Acting

To order: Add stroke length to the end of the part number

Add -T to the end of the part number after stroke for a #5-40 x 1/2" rod thread

